

Bulkhead Light Fitting

Series 6388



www.stahl.de



- > Suitable for incandescent lamps up to 100 W and halogen lamps up to 77 W
- > Through-wiring possible



12797E00

E2

The innovative layout of lamp-holder and terminals enables Series 6388 light fittings to be mounted without heat-resistant cables and without additional junction box.

Zone	ATEX / IECEx					
	0	1	2	20	21	22
For use in		x	x		x	x

WebCode 6388A

Bulkhead Light Fitting

Series 6388

Selection Table

Version	Lamps	Lampholder	Order number	Weight kg
Bulkhead light fitting Series 6388	up to 100 W	E27	6388 / 1-2-2	4.000

Note The light fittings are supplied without lamps, see accessories.

Explosion Protection

Global (IECEX)

Gas and dust
IECEX IBE 14.0014
Ex d e IIB+H₂ T* Gb
Ex tb IIIC T125 °C Db

Europe (ATEX)

Gas and dust
IBExU 03 ATEX 1118
⊕ II 2G Ex d e IIB+H₂ T* Gb
⊕ II 2D Ex tb IIIC T125 °C Db

Certifications and certificates

Certificates
IECEX, ATEX, Kazakhstan (GOST-K), Russia (GOST-R), Serbia (SRPS), Belarus (operating licence)
* Temperature classes

Lamps	Note	max. ambient temperature	Lamp power	Temperature class in operating position		
				Ceiling mounted luminaire	Wall mounted luminaire	
					horizontal	vertical upwards
Incandescent lamps 230 V according to EN 60064	Internal reflector coloured glass	+40 °C	100 W	T1 ¹⁾²⁾	T1	T1
		+40 °C	100 W	T1 ¹⁾²⁾	T1	T1
		+40 °C	100 W	T1 ¹⁾²⁾	T1	T1
		+40 °C	60 W	T2	T2	T2
		+60 °C	≤60 W	T2 ¹⁾²⁾	T2 ¹⁾²⁾	T2
		+40 °C	25 W	T3	T3	T3
Incandescent lamps 24 V		+40 °C	100 W	T1 ¹⁾²⁾	T1 ¹⁾²⁾	T1 ¹⁾²⁾
		+40 °C	60 W	T2	T2	T2
		+60 °C	≤60 W	T2 ¹⁾²⁾	T2 ¹⁾²⁾	T2
Halogen lamp 230 V ³⁾		+40 °C	≤77 W	T1	T1	T1

¹⁾ Temperature resistant cable required, permissible operating temperature ≥ 90 °C

²⁾ Temperature resistant cable gland required, permissible operating temperature ≥ 90 °C

³⁾ Use the following halogen lamps: OSRAM ECO PRO CLASSIC A, max. 77W / 230V

Bulkhead Light Fitting

Series 6388

Technical Data

Electrical data

Rated voltage	230 V AC / DC 24 V AC / DC
Degree of protection	IP64 (IEC 60529)
Protection class	I (with internal and external PE / PA connection)

Luminous characteristics

Lamps	Incandescent lamps, E27, for 25, 40, 60, 100 W Halogen lamps E27, max. 77 W								
Note	Only incandescent lamps according to EN 60064 must be used! Only the following halogen lamps must be used: OSRAM ECO PRO CLASSIC A. Shock-proof incandescent lamps are excluded from the EU directive for energy efficiency.								
Luminous flux	Incandescent lamps				Halogen lamps				
	25 W	40 W	60 W	100 W	20 W	30 W	46 W	57 W	77 W
	200 lm	325 lm	575 lm	1160 lm	235 lm	405 lm	700 lm	915 lm	1320 lm

Luminous intensity distribution

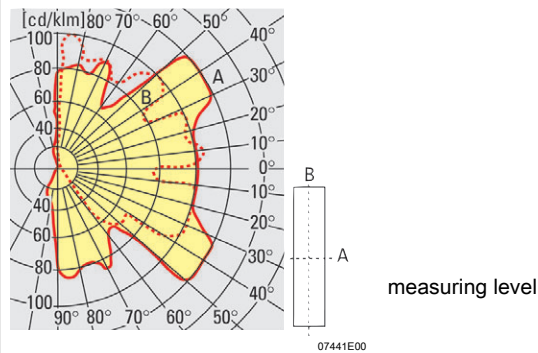

Ambient conditions

Ambient temperature	-60 ... +40 °C - 60 ... + 60 °C @ incandescent lamps ≤ 60W
---------------------	---

Mechanical data

Material	
Enclosure material	Light cast alloy, grey
Wire guard	Steel wire, galvanized
Glass	Pressed glass, resistant to temperature changes
Cover lock	M6, Hexagonal screw; without switch

Mounting / Installation

Cable entry	1 x M25 x 1.5 cable gland 1 x M25 x 1.5 stopping plug
Connection type	0.75 ... 2.5 mm ² (solid, finely and extra finely stranded) 4 mm ² (solid and finely stranded)

Bulkhead Light Fitting

Series 6388

Accessories and Spare Parts

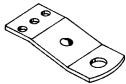
Designation	Figure	Description	Art. no.	Weight kg
Incandescent lamp	 04958E00	25 W E27 230 V 200 lm	111711	0.040
		40 W E27 230 V 325 lm	111712	0.035
		60 W E27 230 V 575 lm	111713	0.035
		100 W E27 230 V 1160 lm	108853	0.033
		60 W E27 24 V ▽	108860	0.042
		100 W E27 24 V 1160 lm	109340	0.020
Mounting brackets	 05267E00	1 set	121705	0.115

Dimensional Drawings (All Dimensions in mm) - Subject to Alterations

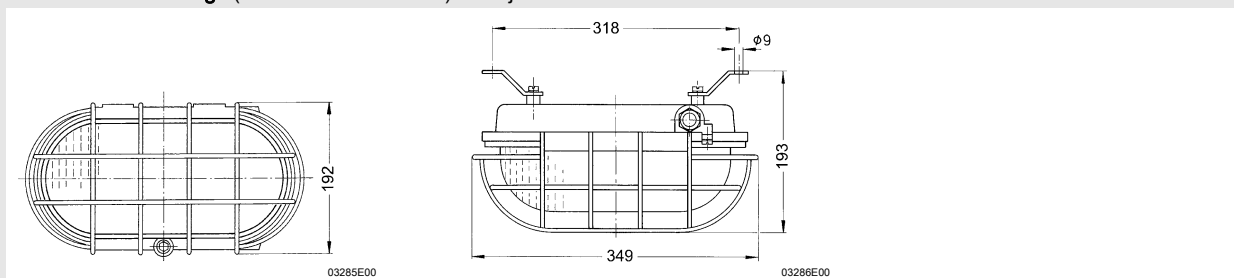

We reserve the right to make alterations to the technical data, dimensions, weights, designs and products available without notice. The illustrations cannot be considered binding.